

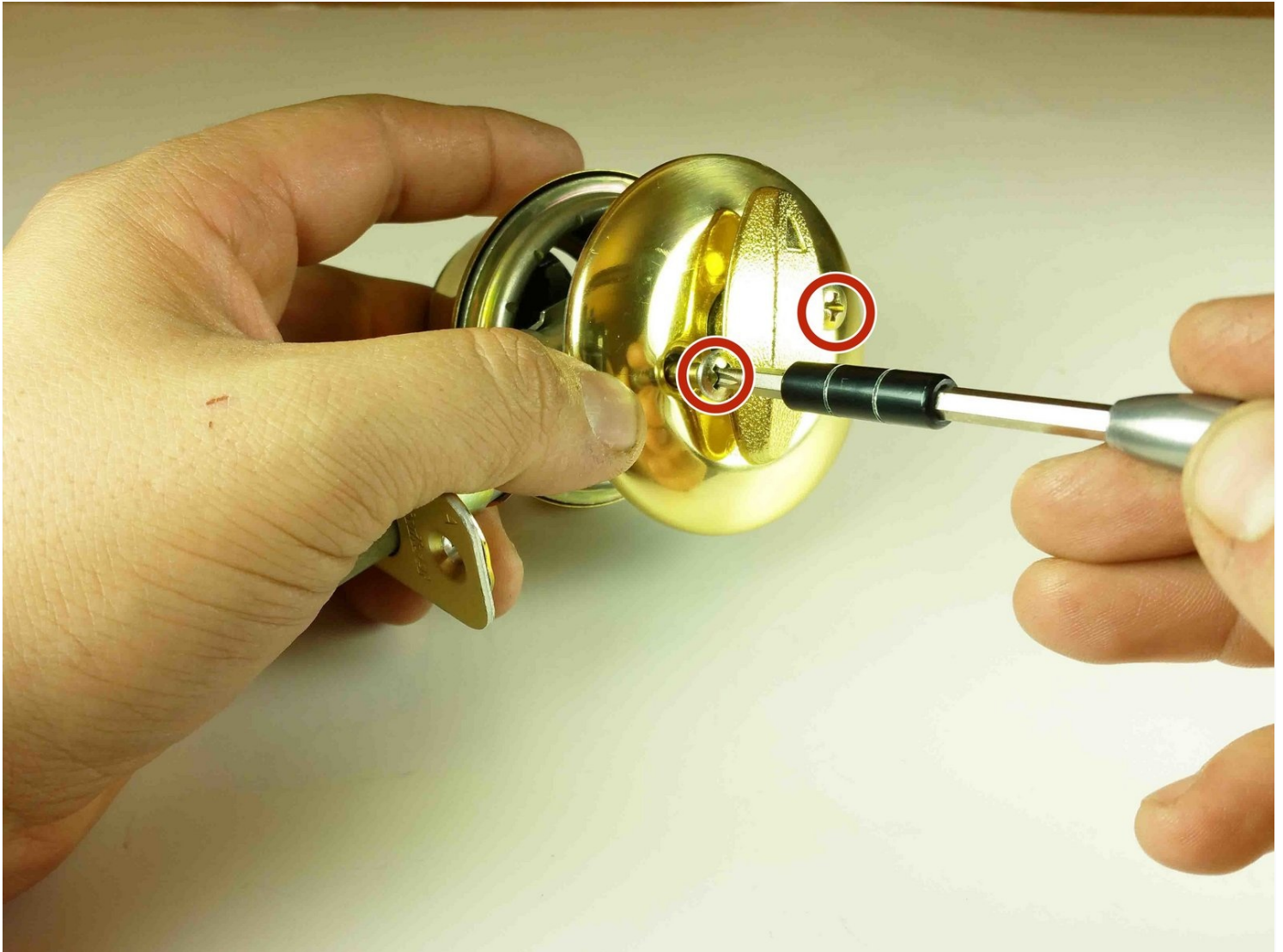

How to Rekey a Kwikset Deadbolt Lock

This guide will help with the process of...

Written By: cmcmilla



INTRODUCTION

This guide will help with the process of Re-keying a Deadbolt Lock in your door. For purposes of clarity, this guide has the deadbolt out of the door so each part can be seen with as much detail as possible. Re-keying a lock is useful for improving the security of a home and it can replace previous keys that you have lost or may have been unknowingly copied. Many steps of this process contain small parts, so proceed with caution in this fix.

Note: This re-keying was performed on a Kwikset deadbolt, but the procedure should be the same for most brands.

TOOLS:

Slip Joint Pliers (1)
Tweezers (1)
6-in-1 Screwdriver (1)
Phillips #2 Screwdriver (1)

PARTS:

Kwikset Deadbolt Lock (1)
The new set of keys (1)
New bottom pins (1)

Step 1 — How to Rekey a Kwikset Deadbolt Lock

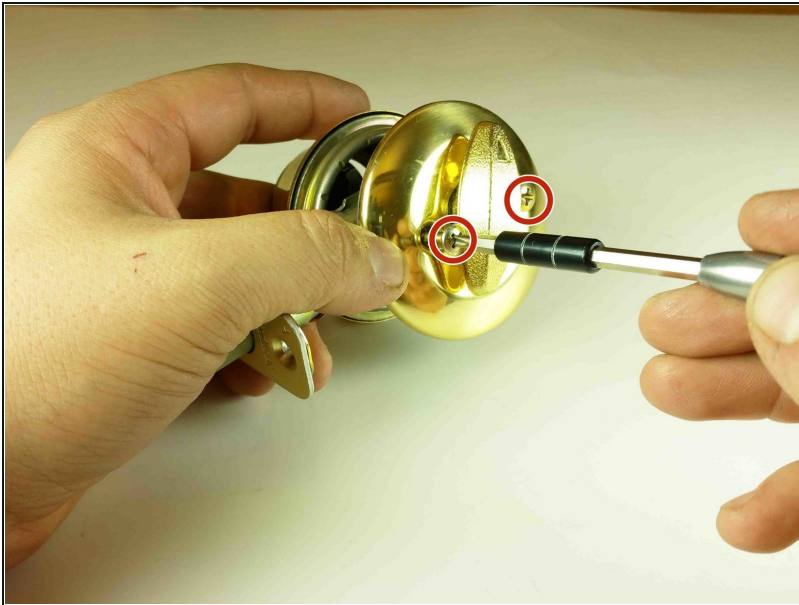

- Remove the mounting screws from the thumb-turn side of the lock assembly using a Phillips screwdriver.

Step 2



- Remove the cylinder assembly from the lock assembly.

Step 3

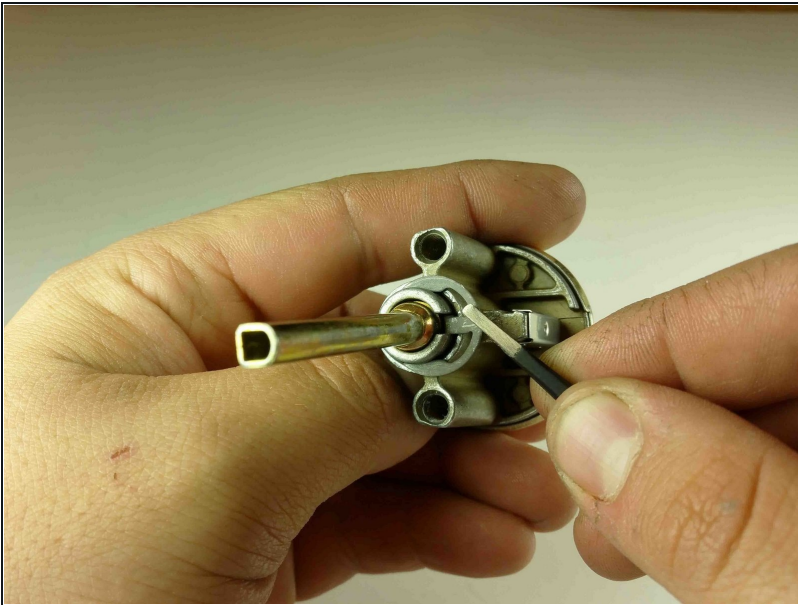

- Remove the retaining clip from the back of the cylinder assembly using [tweezers](#) or pliers.
⚠ The clip is delicate and can be broken.

Step 4



- Remove the tail from the assembly.
 - ★ Note the direction the slit in the tail is facing so you can place it back into the cylinder the same way in came out.

Step 5



- Remove the spring cover with the cylinder in the upright position using a Flathead screwdriver.
 - ⓘ The springs are compressed and may jump out at you.

Step 6

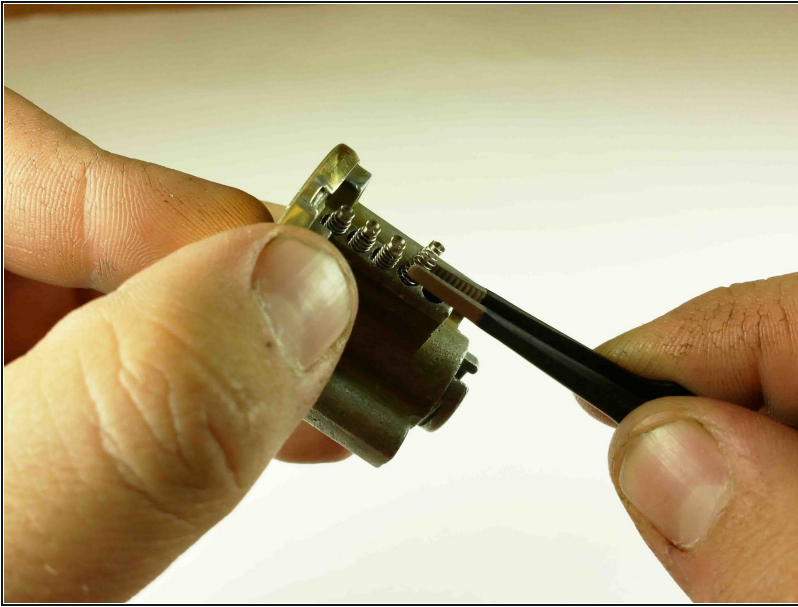

- Remove the springs carefully with tweezers or pliers and set the springs aside as they will need to be put back in during reassembly.

⚠ Be careful when pulling the springs out of the assembly. If the springs are bent or stretched too much, they will be unusable.

Step 7

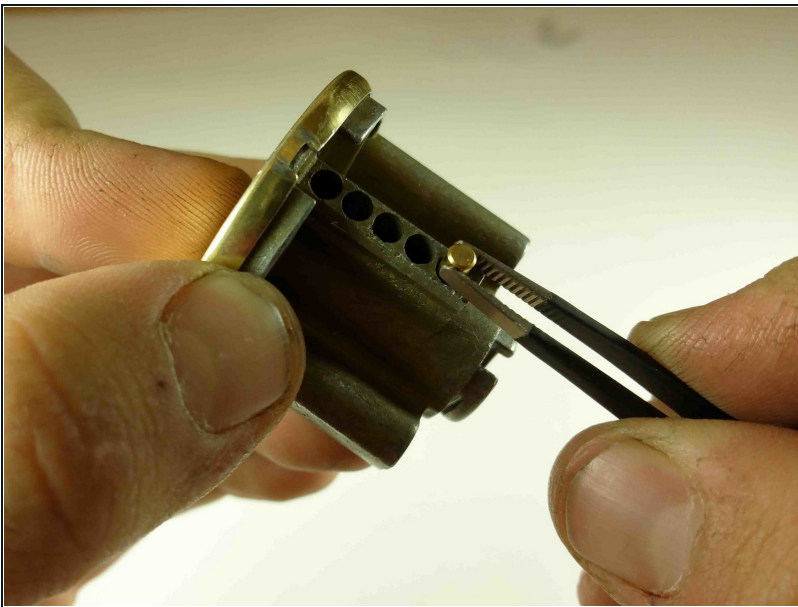

- Remove the top pins using tweezers or pliers.
- ★ There are two sets of pins, bottom and top, be careful not to mix them. Top pins are flat on both sides. These pins are the top pins and they will be reused for reassembly.

Step 8



- Remove the plug from the cylinder assembly in the upright position so the bottom pins do not fall out.

Step 9

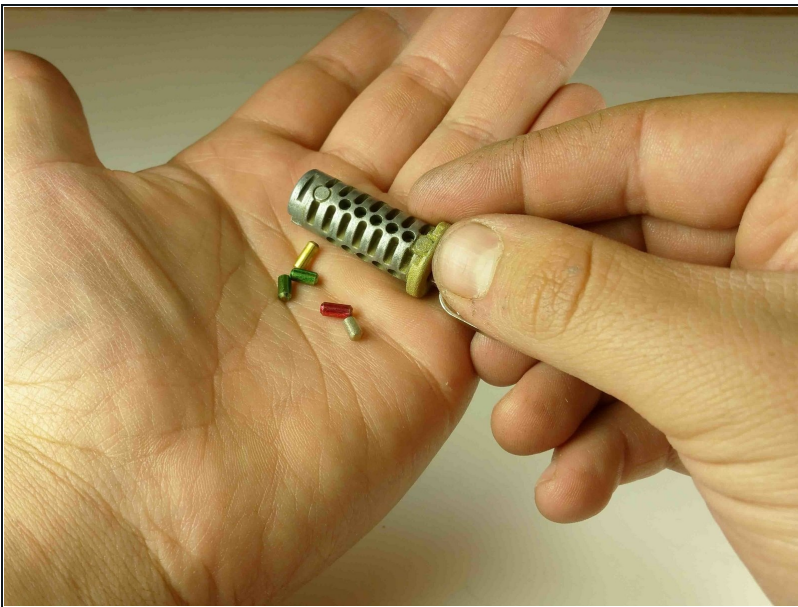

- Remove the bottom pins from the plug. This can be done easily by turning over the plug and dumping them out.
- ① There are two sets of pins, bottom and top, be careful not to mix them. Bottom pins have a cone shape on both ends. These pins are the bottom pins and they will be replaced for reassembly.

Step 10



- Place the new keys into the plug.

Step 11



- Place the bottom pins into the pin holes until the top of the new pin matches the shear line.
 - ☒ Pins that are in the correct position will be flush with the shear line. Incorrect pin placement will be above or below the shear line. The red circle displays an incorrect placement as the pin is above the shear line.

To reassemble your device, follow these instructions in reverse order from step 8.