



DYMO LabelPOINT 100 Battery Replacement

Replace faulty or drained batteries that keep the device from turning on.

Written By: Mike Dam





PARTS:

- [6 AAA Batteries](#) (1)
-

Step 1 — Removing Battery Cover

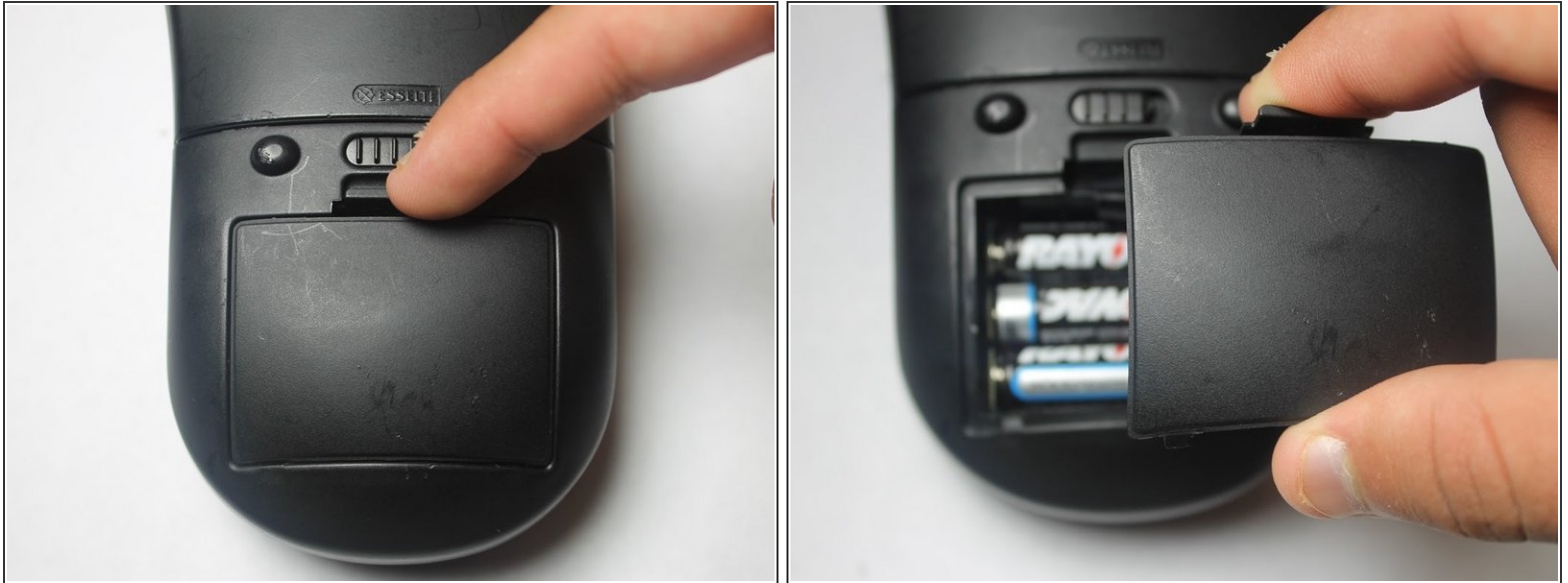

- Slide the battery cover release button.
- Remove battery cover.

Step 2 — Removing Batteries



- Remove all six Triple A batteries.
- i** If applicable, pull on the black ribbon to release all six Triple A batteries at the same time.
- ⚠** Be careful not to damage any of the spring terminals when removing the batteries.

To reassemble your device, follow these instructions in reverse order. If applicable, make sure to set the black ribbon first for future disassembly.