



Saeco Minuto Test Mode

Written By: VauWeh



INTRODUCTION

The Minuto can be put into test mode very easily. It allows you to easily check many functions.

Step 1 — Saeco Minuto Test Mode



- Turn off the machine at the power switch on the back.
- With your left hand, press and hold the top left and bottom right buttons at the same time. On this model, it is the espresso and menu buttons.
- Turn the power switch on the back back on with your other hand. Release the buttons and the machine is in test mode

Step 2

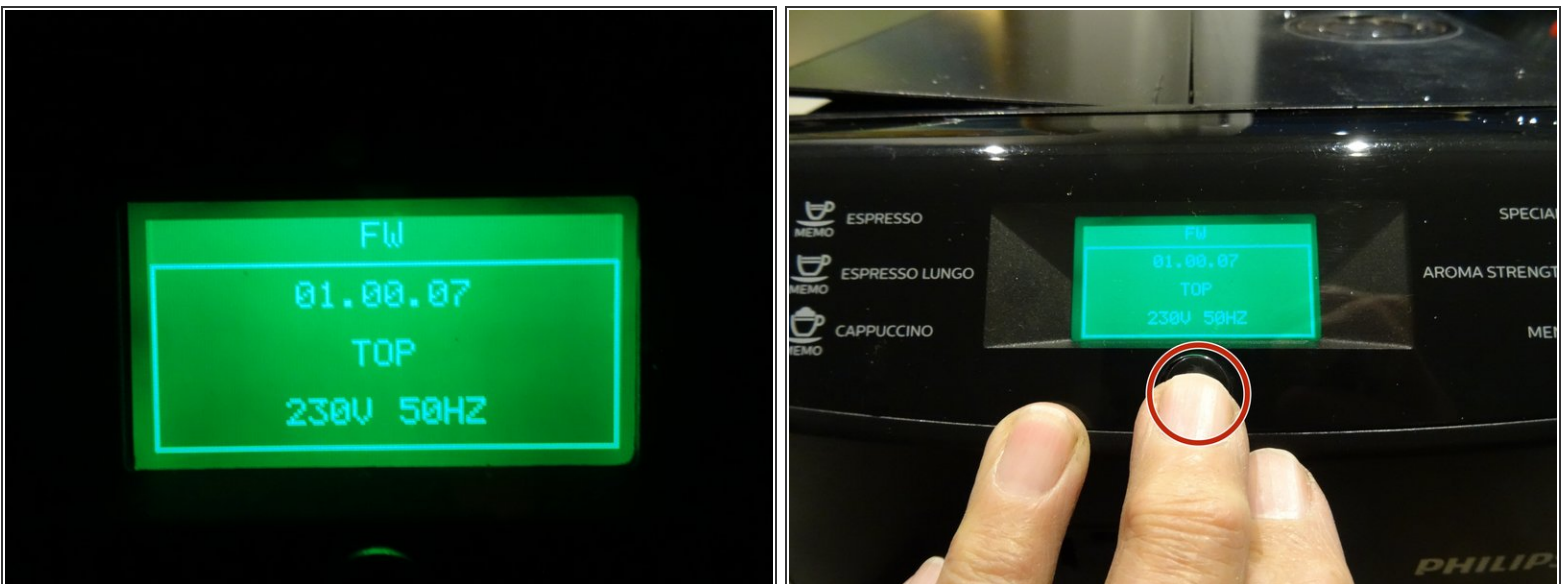

- The first screen shows the technical data and the software version.
- To get to the next screen, tap the power button on the front.

Step 3



- In the next menu you can test the keys. Press one of the keys, then the display should turn red and the corresponding key should appear.
- In the second picture the espresso button is pressed.

Step 4

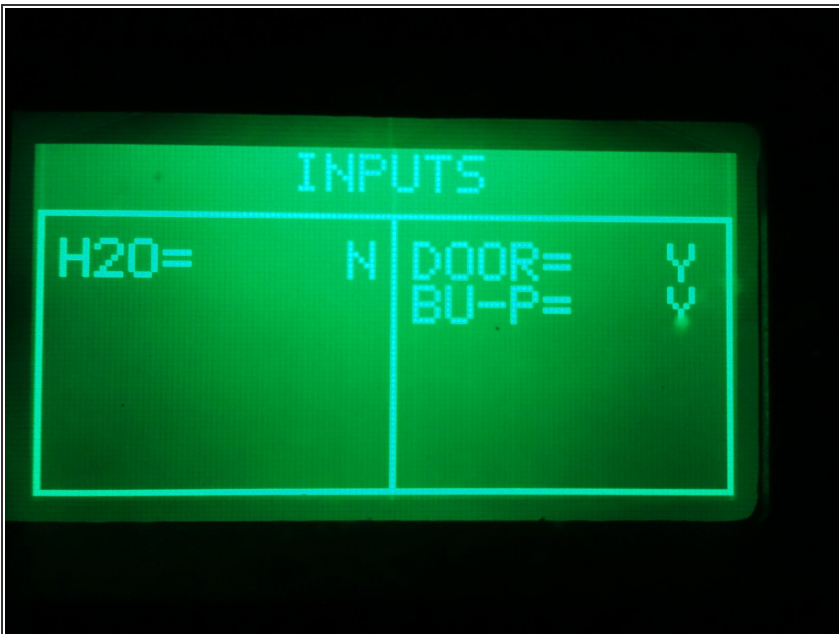

- The sensors are displayed in the third menu. H2O stands for water tank, DOOR for the door sensor, BU-P indicates the brew group sensor. N means no, of course, Y means yes.

Step 5

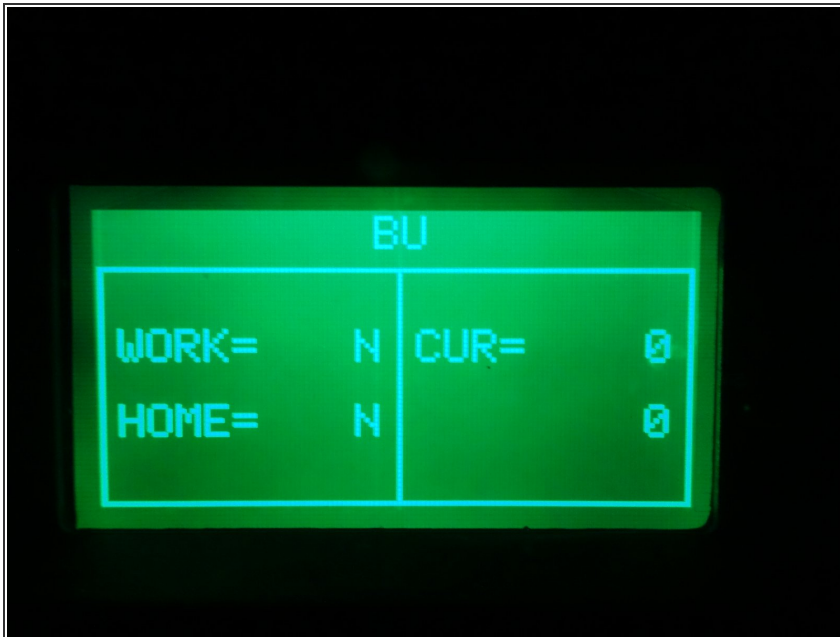

- In the next menu you can test the brew group motor and the sensors for the end position. WORK is the upper end position, HOME is the rest position. CUR outputs the position of the drive shaft.
- To move the engine, briefly tap the top left or middle button.

Step 6

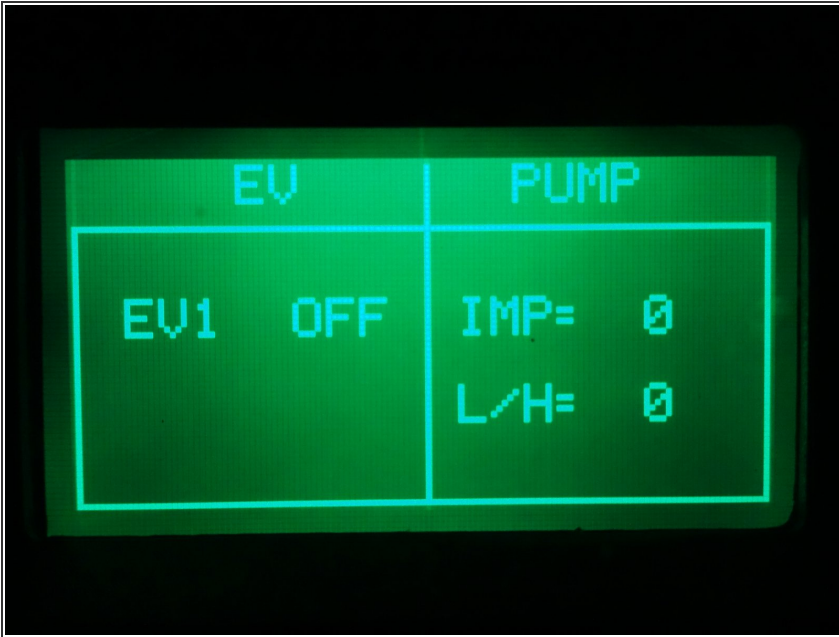

- The next screen is split. The electric valve can be seen on the left, closed here. Press the top left button to shift. On the right the pump or the impulses of the flowmeter. To test, press the top right button.

Step 7

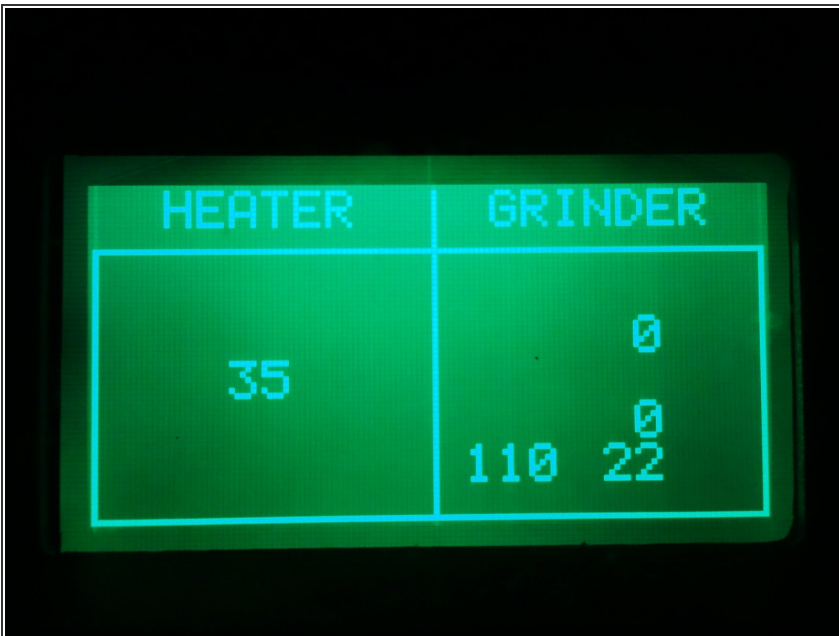

- The next screen is split again. On the left is the temperature of the heater, if you press the top left button, the heater will turn on and the temperature will increase. On the right you can check the grinder by pressing the top right button, key figures for the motor are displayed.
- The next key press takes you back to the beginning. To exit test mode, turn the device off and on again using the power switch on the back.

Work the steps in reverse order to reassemble your device.