



How to use the 2010-2017 Suzuki Swift emergency jack

This guide will show how to use the emergency jack included in the 2010-2017 Suzuki Swift.

Written By: knipwim



INTRODUCTION

The included emergency jack should only be used for changing wheels, and is rated for lifting 950 kg.

Warning: Using the emergency jack can be dangerous due its inability to evenly distribute the vehicle's weight. Additionally, the placement of the emergency jack should correspond with the jack supports underneath the vehicle to prevent slippage of the jack.

Step 1 — retrieve jack

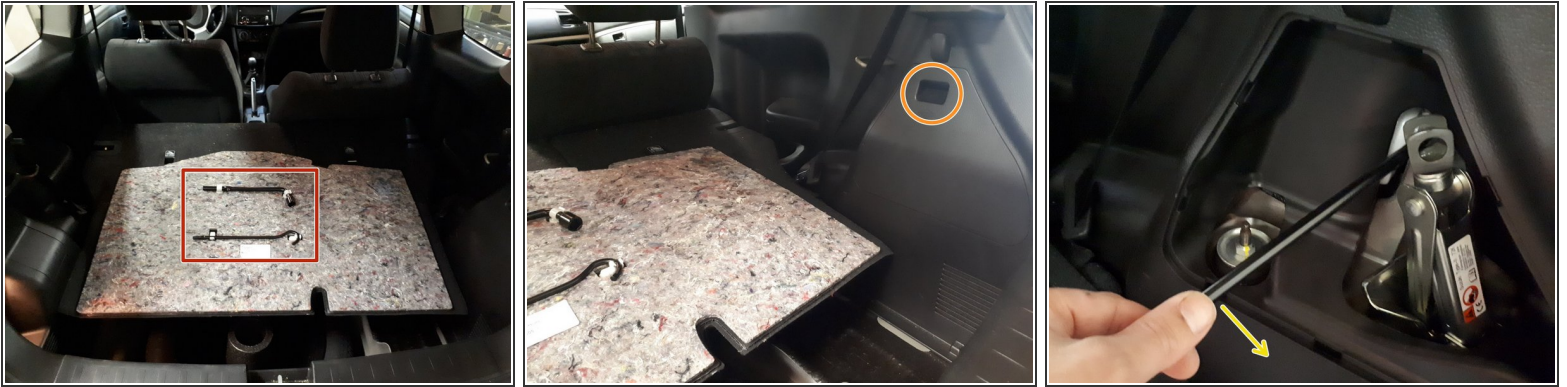

- Open the boot, turn over the floor and retrieve the jack crank and the tire iron.
- Open the compartment where the jack is located.
- Using the jack crank, turn the jack axle counter clockwise to unsecure it from the compartment and pull it out.

Step 2 — position jack



- There are 4 u-shaped jack supports underneath the car, located next to each wheel.
- Turn the jack axle by hand until the support slot of the jack can be placed on the support.

⚠ Only use the emergency jack on the jack supports.

⚠ Make sure the car is on a hard level surface.

⚠ Make sure the jack has at least 51mm load free displacement from its starting position.

Step 3 — jack up the car

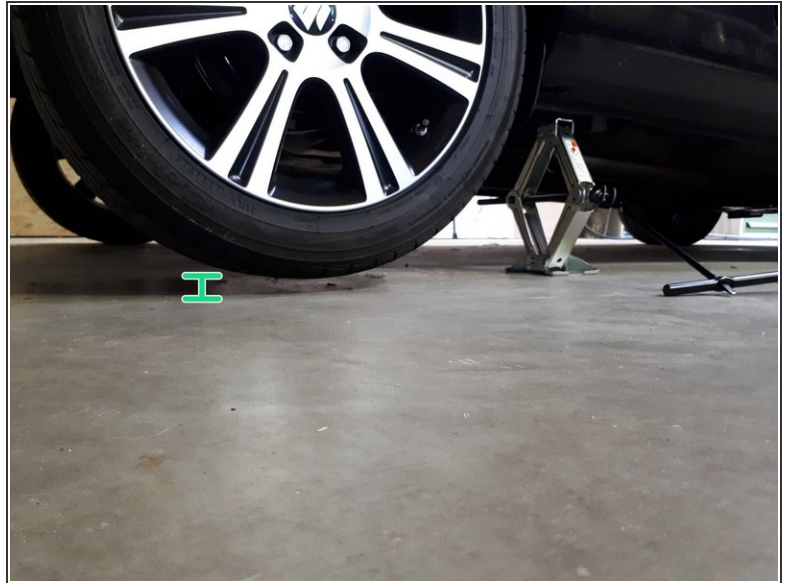
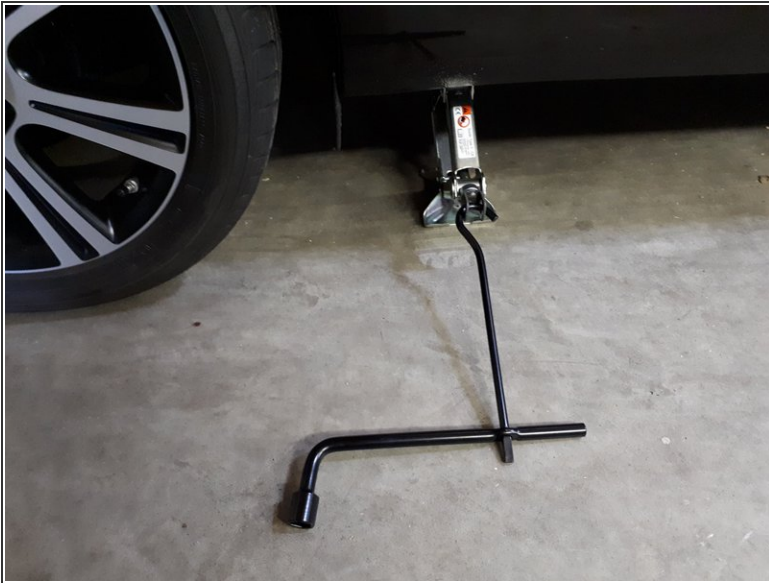

- ⚠ Make sure the handbrake is on, and the gear is in **reverse** for manual or **park** for an automatic transmission car.
- ⚠ Make sure no people are in the car when the car is jacked up.
 - Place the jack crank on the jack axle, and using the tire iron, turn clockwise.
 - Stop cranking when the wheel is high enough from the ground to be replaced.
- ⚠ Do not go underneath the car while it is jacked up with the emergency jack.

Follow these instructions in reverse order to lower the car and put the tools back.